

SLD20, SLD25
BLD20, BLD25

ASSEMBLY VIEW FOR SPORTFISHER REELS

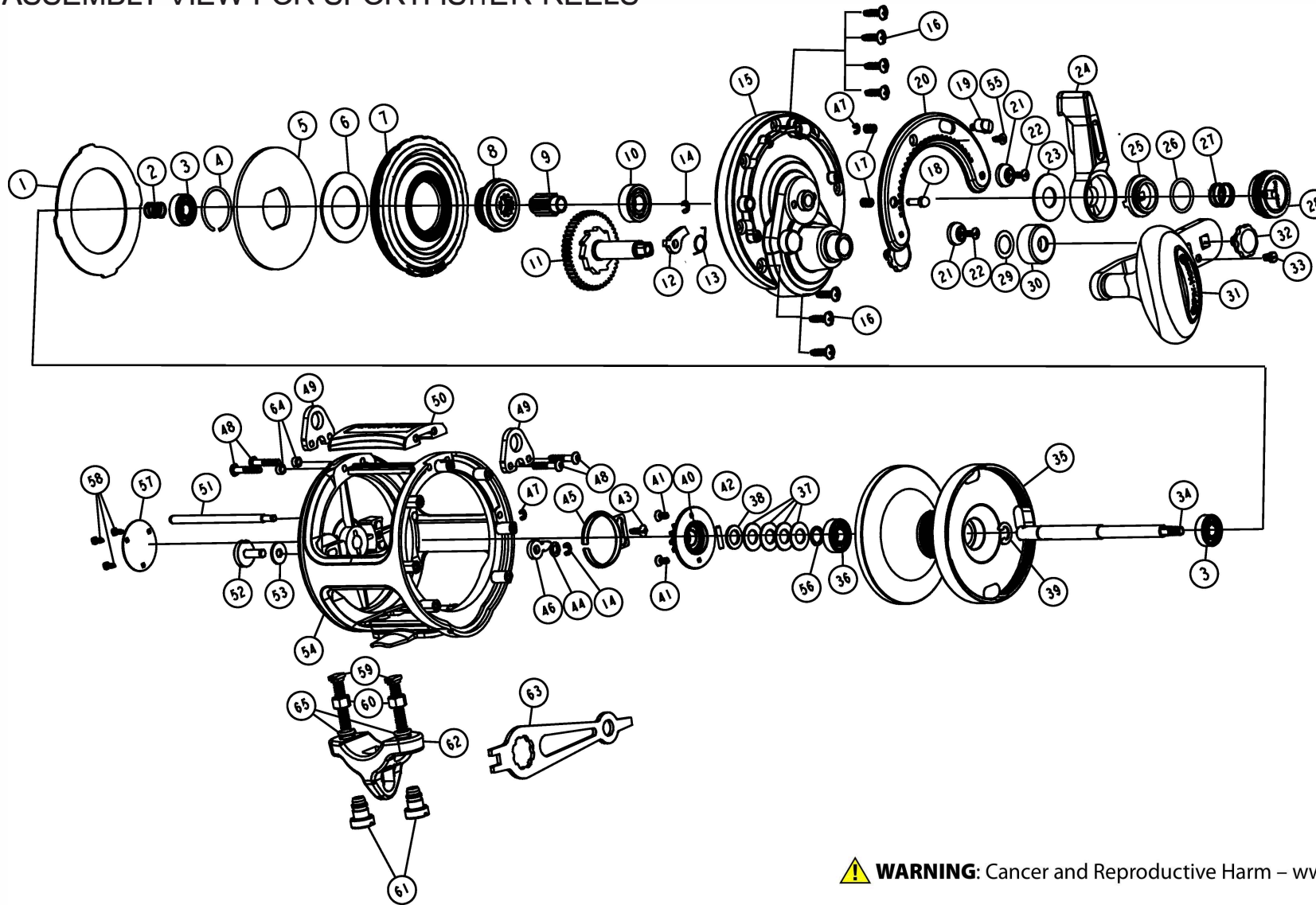

⚠ WARNING: Cancer and Reproductive Harm – www.P65Warnings.ca.gov/products

| Key No. | Description | Part No. SLD20 | SLD25 | BLD20 | BLD25 |
|---------|-------------------------|----------------|-------|-------|-------|
| 1 | Drag Disc | XF059-01 | ↔ | ↔ | ↔ |
| 2 | Pressure Release Spring | XF040-01 | ↔ | ↔ | ↔ |
| 3 | Ball Bearing | BF017-01 | ↔ | ↔ | ↔ |
| 4 | Ring | XF080-01 | ↔ | ↔ | ↔ |
| 5 | Drag Washer | XF045-01 | ↔ | ↔ | ↔ |
| 6 | Spring Washer | XF046-01 | ↔ | ↔ | ↔ |
| 7 | Spool Cover Assembly | XF351-01 | ↔ | ↔ | ↔ |
| 8 | Pinion Holder | XF129-01 | ↔ | ↔ | ↔ |
| 9 | Pinion Gear | XF011-01 | ↔ | ↔ | ↔ |
| 10 | Ball Bearing | XF058-01 | ↔ | ↔ | ↔ |
| 11 | Drive Gear Assembly | XF312-01 | ↔ | ↔ | ↔ |
| 12 | Anti Reverse Pawl | XF063-01 | ↔ | ↔ | ↔ |
| 13 | Pawl Spring | XF096-01 | ↔ | ↔ | ↔ |
| 14 | E-Clip | NX090-01 | ↔ | ↔ | ↔ |
| 15 | Side Cover Assembly | YF324-01 | ↔ | ↔ | ↔ |
| 16 | Tapping Screw | XF076-02 | ↔ | ↔ | ↔ |
| 17 | Spring | XF022-01 | ↔ | ↔ | ↔ |
| 18 | Locating Pin | XF041-01 | ↔ | ↔ | ↔ |
| 19 | Strike Button | XF062-01 | ↔ | ↔ | ↔ |
| 20 | Quadrant | XF152-01 | ↔ | ↔ | ↔ |
| 21 | Locating Collar | XF088-01 | ↔ | ↔ | ↔ |
| 22 | Tapping Screw | ZW125-02 | ↔ | ↔ | ↔ |

| Key No. | Description | Part No. SLD20 | SLD25 | BLD20 | BLD25 |
|---------|-------------------------|----------------|-----------|----------|-----------|
| 23 | Washer | XF038-01 | ↔ | ↔ | ↔ |
| 24 | Drag Lever Assembly | YF355-01 | ↔ | ↔ | ↔ |
| 25 | Cam | XF028-01 | ↔ | ↔ | ↔ |
| 26 | O-Ring | XF101-01 | ↔ | ↔ | ↔ |
| 27 | Coil Spring | YF040-01 | ↔ | ↔ | ↔ |
| 28 | Pre Set Knob Assembly | XF329-01 | XF329-02 | XF329-03 | XF329-03 |
| 29 | Washer | XF035-01 | ↔ | ↔ | ↔ |
| 30 | Cap | XF145-01 | ↔ | ↔ | ↔ |
| 31 | Handle Assembly | YF318-01 | ↔ | ↔ | ↔ |
| 32 | Handle Nut | XF003-01 | ↔ | ↔ | ↔ |
| 33 | Screw | CF065-01 | ↔ | ↔ | ↔ |
| 34 | Spool Shaft | XF015-01 | YF015-01A | XF015-01 | YF015-01A |
| 35 | Spool | XF021-01 | YF021-01A | XF021-01 | YF021-01A |
| 36 | Ball Bearing | KF017-01 | ↔ | ↔ | ↔ |
| 37 | Drag Spring | JF046-01 | ↔ | ↔ | ↔ |
| 38 | Washer | CF121-01 | ↔ | ↔ | ↔ |
| 39 | E-Clip | DF092-01 | ↔ | ↔ | ↔ |
| 40 | Ratchet Holder Assembly | YF329-01 | ↔ | ↔ | ↔ |
| 41 | Screw | TW107-02 | ↔ | ↔ | ↔ |
| 42 | Spool Shaft Pin | DF093-01 | ↔ | ↔ | ↔ |
| 43 | Screw | QW125-03 | ↔ | ↔ | ↔ |
| 44 | Washer | CF035-01 | ↔ | ↔ | ↔ |

| Key No. | Description | Part No. SLD20 | SLD25 | BLD20 | BLD25 |
|---------|--------------------|----------------|----------|----------|----------|
| 45 | Click Spring Plate | DF022-01 | ↔ | ↔ | ↔ |
| 46 | Bait Click Pawl | DF109-01 | ↔ | ↔ | ↔ |
| 47 | E-Clip | NX090-01 | ↔ | ↔ | ↔ |
| 48 | Screw | XF123-01 | ↔ | ↔ | ↔ |
| 49 | Harness Lug | XF151-01 | ↔ | ↔ | ↔ |
| 50 | Cross Bar Assembly | XF327-01 | YF327-01 | XF327-02 | YF327-02 |
| 51 | Line Guard | XF004-01 | YF004-01 | XF004-01 | YF004-01 |
| 52 | Bait Click Lever | XF109-01 | ↔ | ↔ | ↔ |
| 53 | Washer | CF032-01 | ↔ | ↔ | ↔ |
| 54 | Frame Assembly | XF301-01 | YF301-01 | XF301-02 | YF301-02 |
| 55 | Tapping Screw | QW107-01 | ↔ | ↔ | ↔ |
| 56 | Washer | XF032-01 | ↔ | ↔ | ↔ |
| 57 | Medallion | RF169-01 | ↔ | ↔ | ↔ |
| 58 | Tapping Screw | XF053-01 | ↔ | ↔ | ↔ |
| 59 | Rod Clamp Bolt | CF125-01 | ↔ | ↔ | ↔ |
| 60 | Nut | JF003-01 | ↔ | ↔ | ↔ |
| 61 | Rod Clamp Nut | CF161-01 | ↔ | ↔ | ↔ |
| 62 | Rod Clamp | XF154-01 | ↔ | ↔ | ↔ |
| 63 | Wrench Driver | XF113-01 | ↔ | ↔ | ↔ |
| 64 | Spacer | XF094-01 | ↔ | ↔ | ↔ |
| 65 | O-Ring | LF101-01 | ↔ | ↔ | ↔ |



6101 E. Apache • Tulsa, OK 74115
(800) 588-9030
www.finnorffishing.com

ZS3168

Maintenance Notes: _____
Serial Number: _____
Purchase Date: _____



BLD20/25 SLD20/25

PARTS LIST AND ASSEMBLY VIEW